

Big Corkscrew Island Regional Park Public Information Meeting

Collier County Public Services Division
Public Workshop Results



October 30, 2014

Agenda

Introductions

Steve Carnell, Public Services Administrator

Park Overview and Public Involvement Results

Tim Hancock AICP, Stantec

How do we get there?

Comments and Suggestions

Tim Hancock AICP, Stantec

Amanda Townsend,

Operations and Veteran Services Director

Disclaimer: I remain solely responsible for data supplied in electronic format. The recipient accepts full responsibility for verifying the accuracy and completeness of the data. The recipient holds me harmless in all cases, employees, consultants and agents from any and all claims arising in any way from the content or provision of the data.

Stanteo Consulting Services Inc.
3200 Bailey Ln. Ste. 200
Naples, FL 34105
tel 239.649.4040
fax 239.649.5716



Age Group	Percent
18-24	100
25-34	150
35-44	200
45-54	250
55-64	300
65-74	350
75-84	400
85+	450

Reported by: CJS, 10/30/14



2006 BCIRP Master Plan



Public Workshop Results

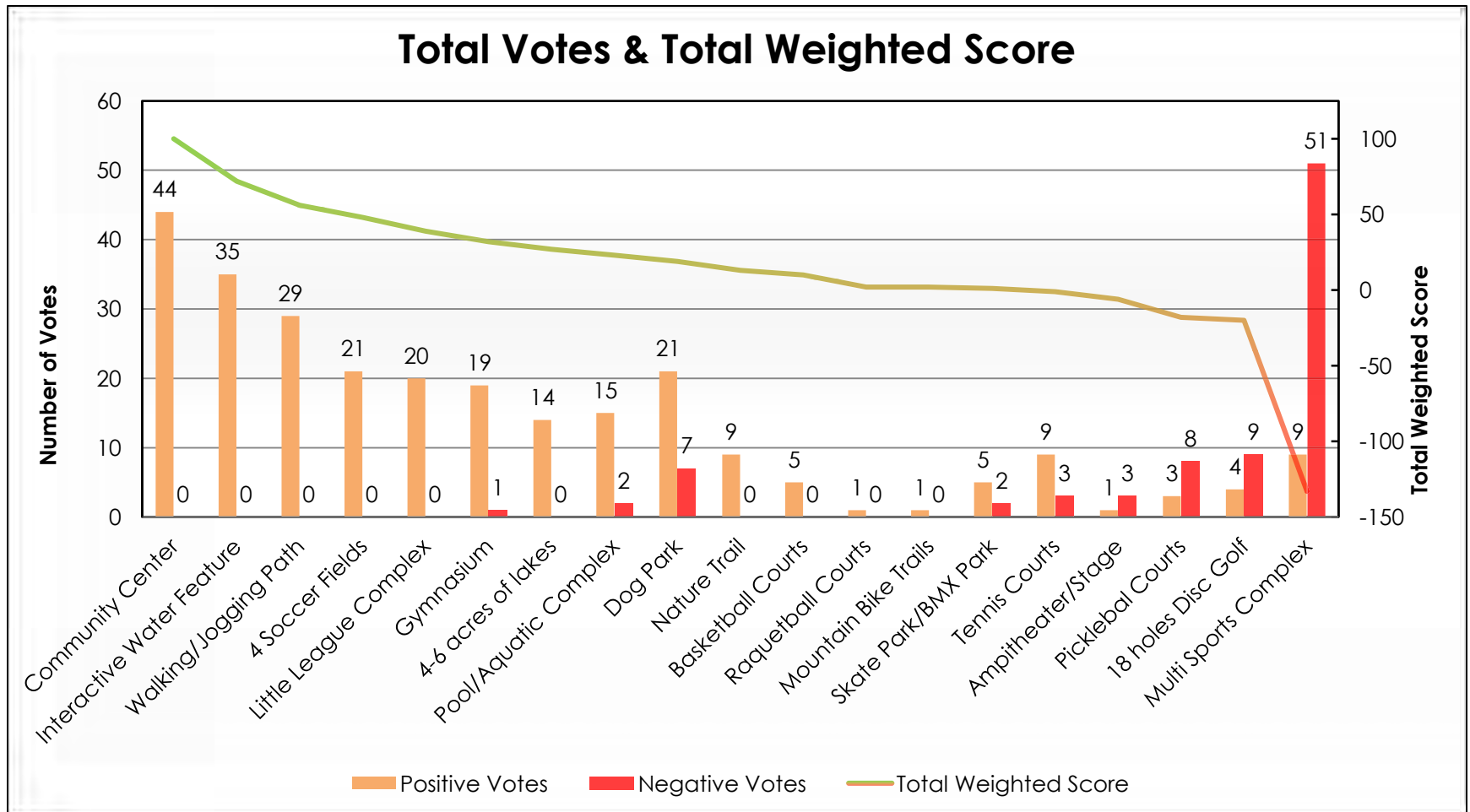

Public Workshop Results

20 Total Elements
87 Total Participants

Rankings & Points

Green dots 1-3

1 = 3 pts

2 = 2 pts

3 = 1 pt

1 Red Dot = -3pts

Park Element	Number of "1" votes	Number of "2" votes	Number of "3" votes	Number of "no" votes	Total "positive" votes	Weighted Score*	Total Weighted Score**
Community center	21	14	9	0	44	100	100
Interactive Water Feature	12	13	10	0	35	72	72
Walking/Jogging Path	8	11	10	0	29	56	56
4 Soccer Fields	11	5	5	0	21	48	48
Little League complex+	8	3	9	0	20	39	39
Gymnasium+	2	12	5	1	19	35	32
4-6 acres of Lakes	5	3	6	0	14	27	27
Pool/Aquatic complex+	3	8	4	2	15	29	23
Dog Park	7	5	9	7	21	40	19
Nature Trail+	0	4	5	0	9	13	13
Basketball Courts	1	3	1	0	5	10	10
Racquetball Courts	0	1	0	0	1	2	2
Mountain Bike Trails+	0	1	0	0	1	2	2
Skate Park/BMX Park+	0	2	3	2	5	7	1
Tennis Courts	1	0	5	3	9	8	-1
Amphitheater/Stage+	1	0	0	3	1	3	-6
Pickleball Courts+	1	1	1	8	3	6	-18
18 Holes Disc Golf	1	1	2	9	4	7	-20
Multi Sports Complex+	5	1	3	51	9	20	-133

+ Park Element Not Included in 2006 Plan

* Weighted score is calculated by assigning a value of 3 points for a first place vote, 2 points for a second place vote, and 1 point for a third place vote.

**Total Weighted score is the weighted positive votes minus 3 points for each negative vote

Public Workshop Outliers

- Multi Sport Complex
60% Voted Against
- Dog Park
7 Ranked as Top
Priority
7 Voted Against
- 18 Hole Disc Golf
9 Negative Votes
1 Positive

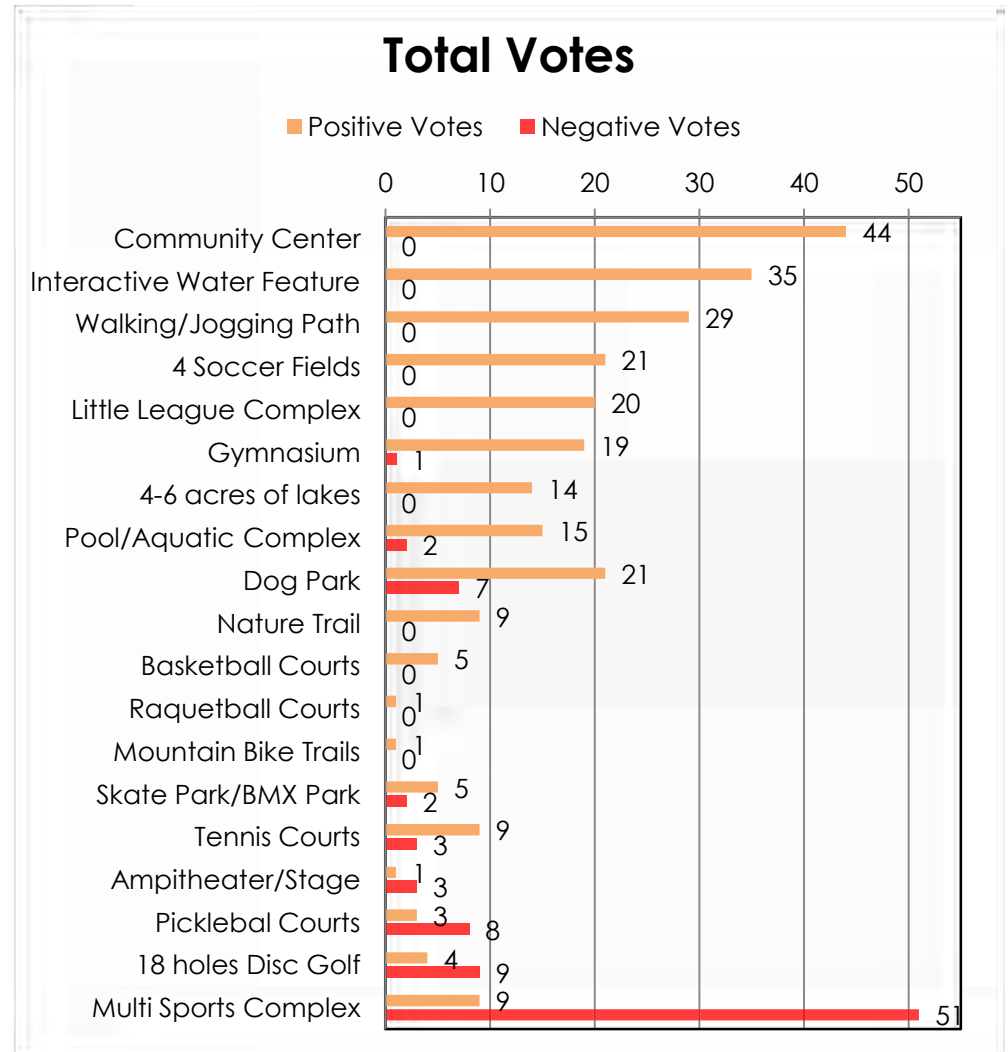

BCIRP Top Priorities

2006 Plan Incorporates the Top Priorities



What Do Our Priorities Cost?

- Community Center
\$300/SF
5,000SF = \$1.5M
9,000SF = \$2.7M
- Interactive Water Feature
\$500,000+
- Walking/Jogging Path
\$31/LF (12' wide)
1 Mile = \$164,000
- Soccer/Multi-Use Fields
\$750,000/Ea
4 Fields = \$3M

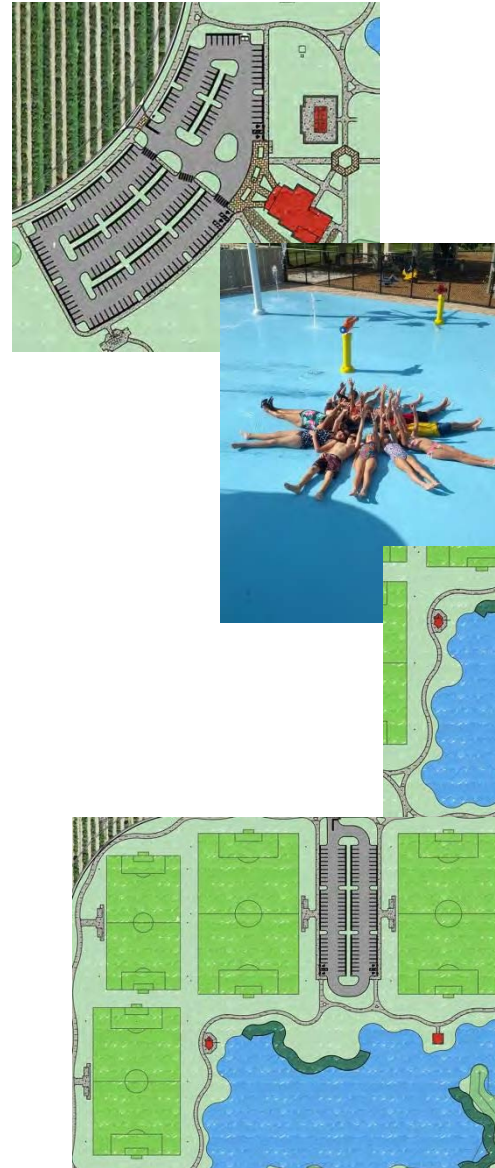

Understanding The Process

- Final Design and Infrastructure
Roads, Water, Sewer, Water
Management, Parking, etc.
- How Best Do We Allocate Funds?
Trade-offs
Future budget allocations
- Constructed in Phases
Priorities must be balanced with
needs

We Aren't Finished, Yet!

- Build off of the 2006 Master Plan
- Continue to Evaluate Alternatives
- Continued Public Involvement



Public Comment Options

- Public Comment Forms
Can be completed before leaving tonight
- Online comments @
www.bcirp.ideascale.com
- Comments & Suggestions

Thank You !!



2006 Design



Soccer / Multi-Purpose Fields – 12 acres



Basketball Courts (2) - .6 acres



Community Center - +/- 5,230 sq. ft.

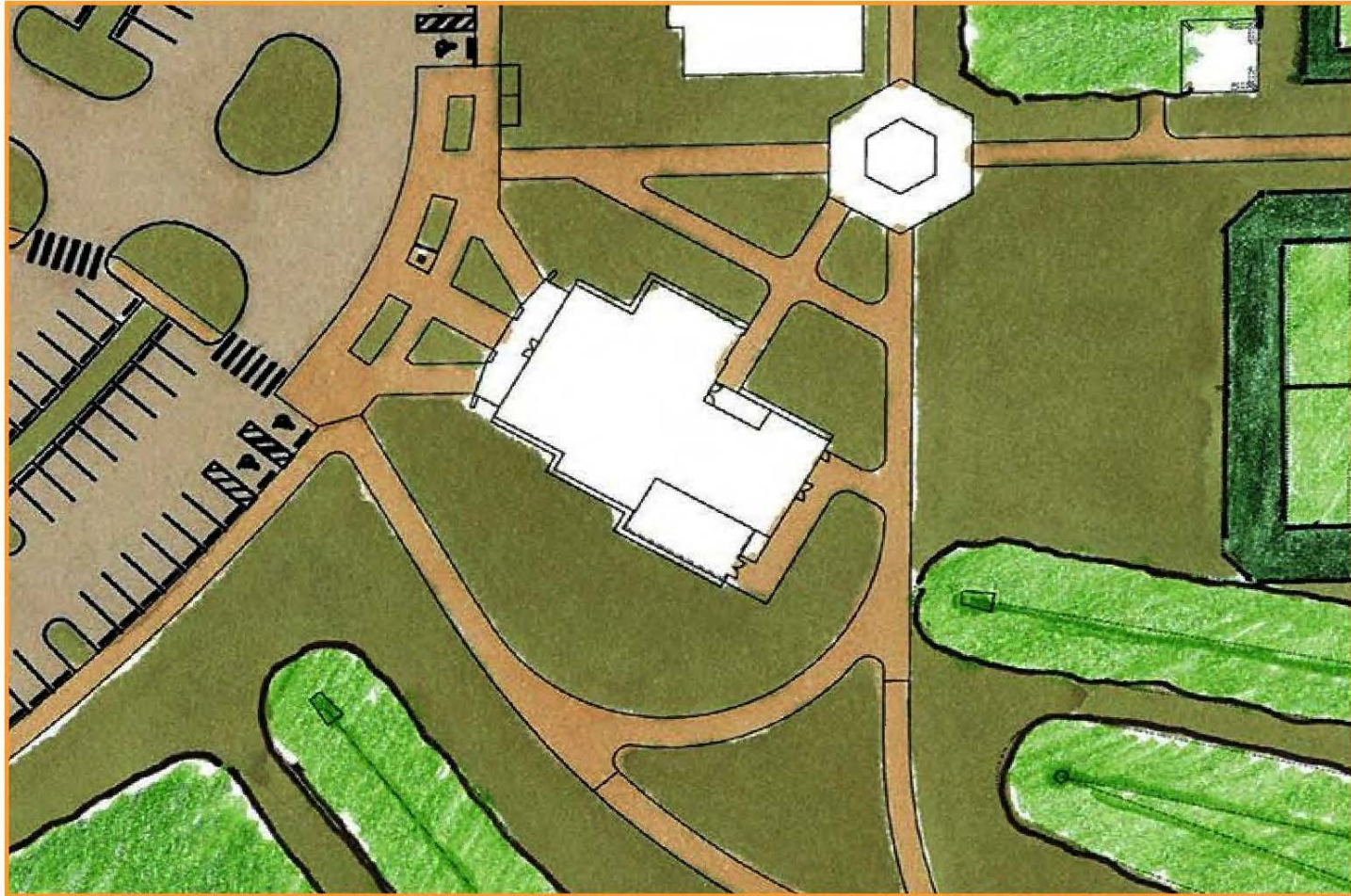

Racquetball Courts (2) - .4 acres



Tennis Courts (4) – 1.25 acres

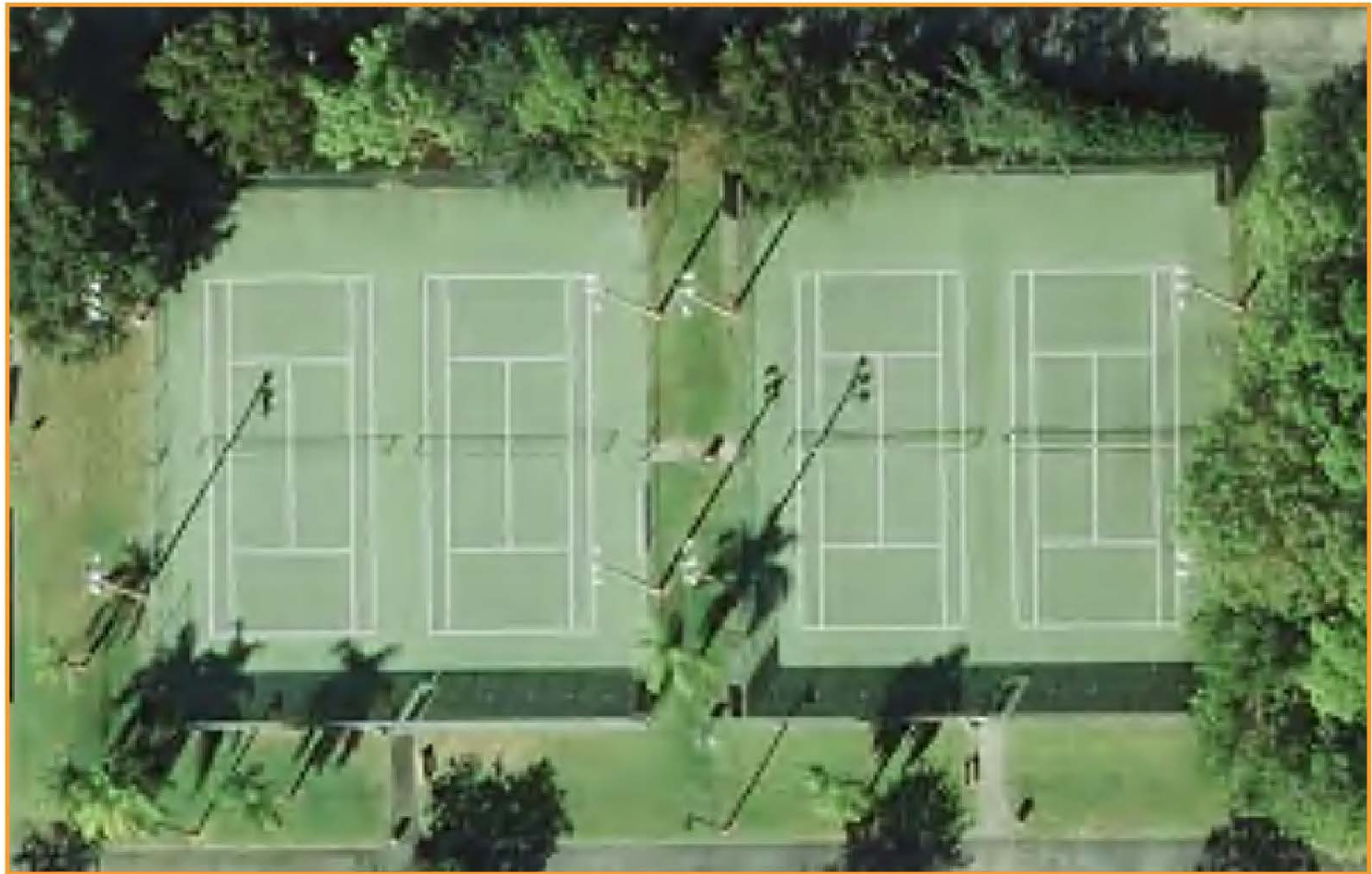

Frisbee Golf (18 holes) – 10 acres



Lakes – 5-6 acres



Walking/Jogging Path with Pavilions

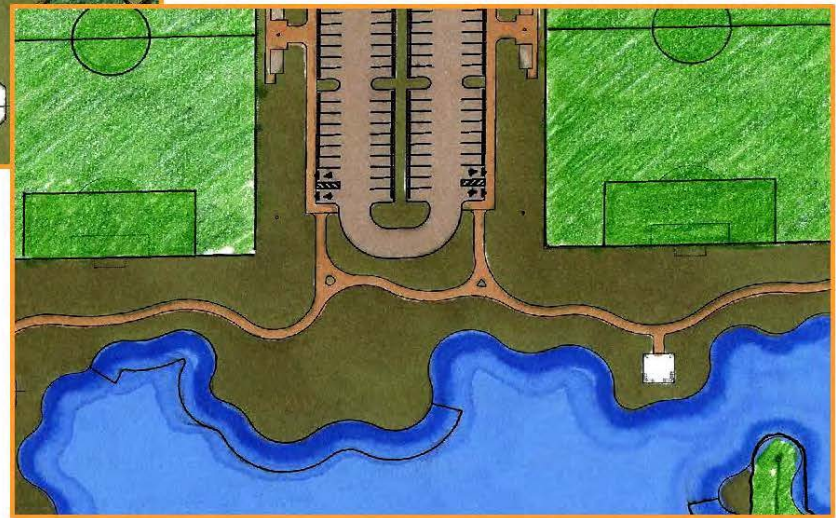

Playground



Interactive Water Feature



Dog Park



Little League Fields



Gymnasium



Pickle Ball Courts





MULTI SPORTS COMPLEX
COLLIER COUNTY PRESENTATION
PUBLIC PRIVATE PARTNERSHIP



MULTI SPORTS COMPLEX



The Southwest Florida Soccer Foundation, Inc. is a Not-For-Profit 501© 3 Corporation in Collier County. Currently the Foundation is seeking to establish a public/private partnership that creates a fun, safe, state-of-the art full service athletic facility for Southwest Florida.



PROPOSED DEVELOPMENT LAYOUT



PHASED APPROACH



- Build seven grass fields, with rotation for five fields open at all time
 - Build a turf field with special lighting that only lights field



- Build air conditioned Indoor Complex



- Stadium discussion in future but not at same site as complex

OUTDOOR & INDOOR MULTI SPORTS



PHASE 1



- 4 Outdoor Multisport Fields
- Outdoor Volleyball Sand Courts
- 55,000 square foot indoor facility
- 3 Indoor Soccer Fields converting to other sports
 - Nets dividing fields
- Indoor volleyball floor for AAU tourneys

Sports Able To Utilize Facilities

- Soccer
- Futsal
- Volleyball
- Baseball
- Football
- Basketball
- Lacrosse

ELEMENTS ASSOCIATED WITH THE FIELDS



PHASE 2



- 4 Outdoor Multisport Fields
 - Turf Field with lights
- 3 Indoor Basketball Courts
- 6 Indoor Volleyball Courts

Additional Areas:

- Indoor Batting Cages
- Indoor Golf on world's best courses
 - Men's & Ladies Locker Rooms
- Concessions and Merchandise
 - Storage Areas
 - Fitness Center
 - Meeting Rooms
 - Video Rooms

ELEMENTS ASSOCIATED IN THE INDOOR



PHASE 2



- 4 Outdoor Multisport Fields
 - Turf Field with lights
- 3 Indoor Basketball Courts
- 6 Indoor Volleyball Courts

Additional Areas:

- Indoor Batting Cages
- Indoor Golf on world's best courses
 - Men's & Ladies Locker Rooms
- Concessions and Merchandise
 - Storage Areas
 - Fitness Center
 - Meeting Rooms
 - Video Rooms

ELEMENTS ASSOCIATED IN THE INDOOR



WORKING TOGETHER FOR
SOUTHWEST FLORIDA



www.swfladrenaline.com  Stantec

Ideas??



Questions?

Opinions?



Public Services Division
Parks & Recreation

Thank You !!

